

AB 110

YACHT OVERVIEW HULL 207



MAIN CHARACTERISTICS:

Type of Vessel:	Motor Yacht	Gensets:	[2] KOHLER 32 kW each
Shipbuilder:	AB YACHTS, Next Yacht Group	Air Conditioning:	CONDARIA 180.000 BTU
Class & Certification:	✓ R.I.Na - C ✕ HULL • MACH Y - Unrestricted Navigation (Pleasure Yacht)	Bow thruster:	Electric bow thruster, Side Power 320Kg, 220V
Dimensions:	Length Overall (LOA) 33.70 m Maximum Beam 6.80 m Draught 1.30 m	Voltage:	400V, three-phase + neutral, 60Hz
Approx Displacement (Full):	110 Tonnes	Maximum Speed:	41 knots
Propulsion & Main Engines:	[3] MAN V12-2000 (2000 HP) each [2] MJP steerable waterjets + [1] MJP central booster	Cruising Speed:	35 knots @90 % of engine load
		Fuel Capacity:	11.500 litres ca.
		Water Capacity:	2.000 litres

ACCOMMODATIONS:

Owner's Cabin and Guests:

- [1] Suite Owner on the Lower deck
- [1] Vip Cabin on the Lower deck
- [2] Guest Cabins on the Lower deck with folding beds and sliding beds in each Cabin on the Lower Deck

Crew:

- [2] Crew Cabin (4 pax Crew)

Bathrooms:

- [4] Guest bathroom
- [1] Day-head on the Main Deck
- [2] Crew Bathroom with shared shower

























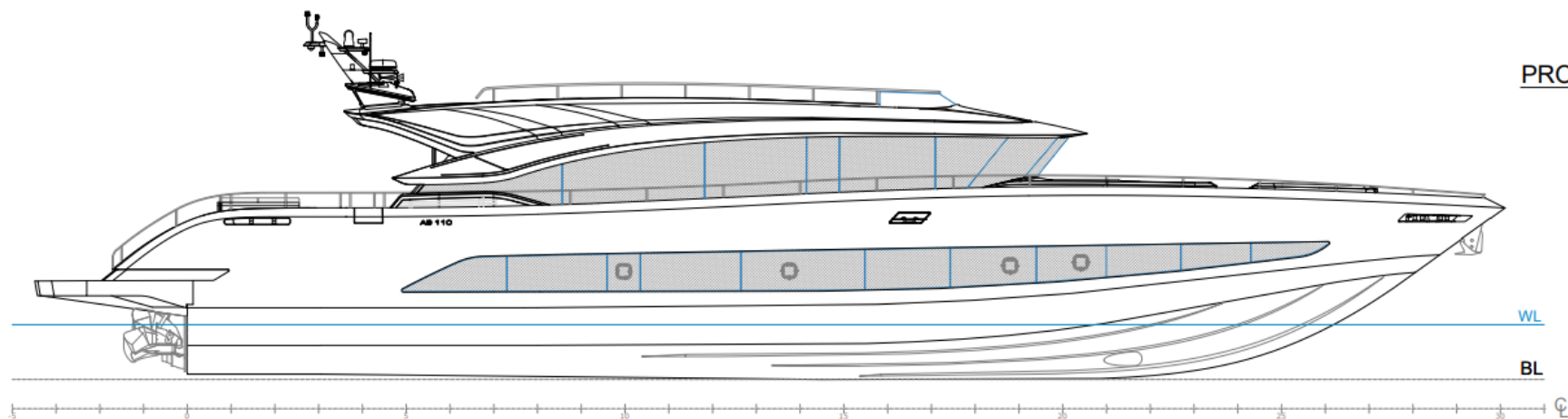

PROFILE

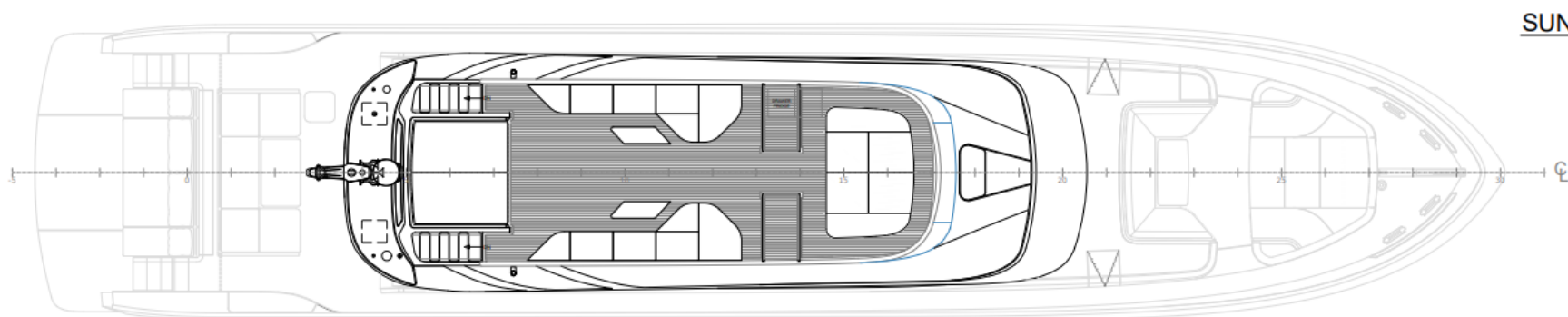

SUN DECK

MAIN DECK

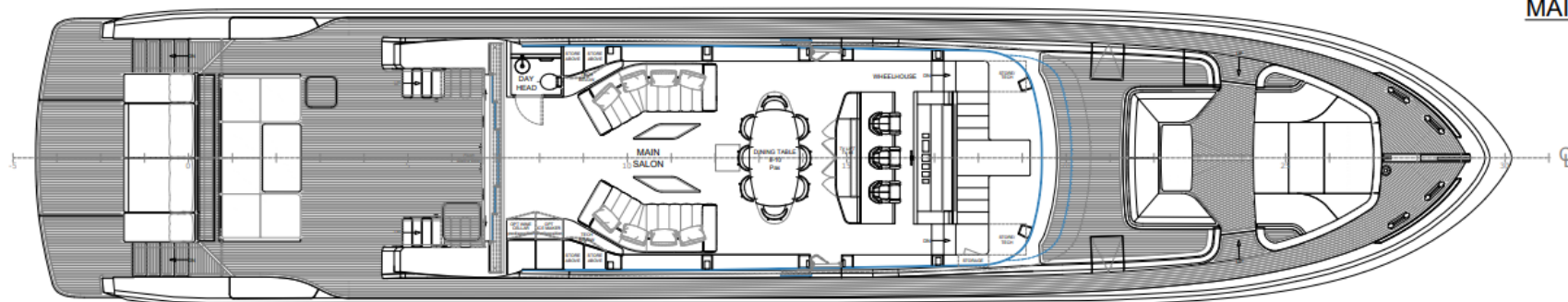

LOWER DECK

- 1 OWNER'S CABIN
- 1 VIP CABIN
- 2 GUEST CABIN
- 2 CREW CABIN
- 1 GALLEY

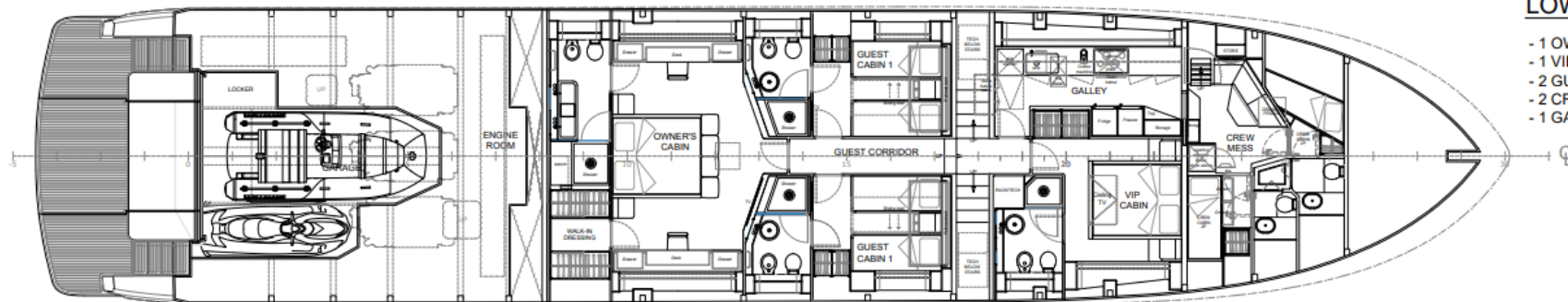

HOUSEHOLD APPLIANCES:

Main Salon and Galley:

- [1] MIELE Oven 60cm
- [1] Cooking top
- [1] MIELE Exhaust hood
- [1] Sink
- [1] MIELE Dishwasher
- [1] LIEBHERR Wine cooler LIEBHERR for about 30 bottles
- [2] LIEBHERR Small fridges
- [1] LIEBHERR Freezer
- [1] RARITAN Icemaker

Crew Mess:

- [1] MIELE Washer
- [1] MIELE Dryer
- [1] MIELE Microwave
- [1] FRIGONAUTICA Fridge

Exterior Area:

- [1] Cooler drawer

[Modifications/Integrations to the following configuration ore given in Annex D]

ELECTRONIC NAVIGATION EQUIPMENT:

On the Main Deck Wheelhouse:

- [2] GARMIN 45" Ultrawide monitors in the upper part of the console installed under a single glass touch screen 2300 x 430 mm
- [2] GARMIN 28" ultrawide 16/3 monitors in the horizontal part. under a single glass touch screen 2300 x 190 mm
- [3] Compact Computer NXT Marine Type Approved
- [2] Panel with PLC + Network switches (to be installed under console)
- [1] Glass touch screen 2300x430mm (indicative measures)
- [1] Glass touch screen 2300x190mm (indicative measures)
- [4] SEASYacht Software license (GAM, Navigation Conning, Automation features, CCTV)
- [2] Software Timezero, Radar, Sounder Module
- [1] Radar: DRS4D-NXT FURUNO RADAR SENSOR RADOME SSD
- [1] Compass SCX-20 FURUNO SATELLITE COMPASS[1] AIRMAR sensor traducer pass plast DST810
- [1] BBDS1 Sounder module
- [1] Echo sensor Airmar SS60 with cable and bronze thru-hull
- [1] Sensor Triducer Airmar DST810 with bronze thru-hull
- [1] Weather Station AIRMAR 220WX
- [1] Antenna GPS 24xd Cavo10m
- [1] VHF ICOM IC-M 605
- [1] Sailor 7222 VHF (with DSC) Class A certified complete of antenna and remote handset
- [1] AIS ATB1 AIS Classe B complete with cables and antenna
- [1] Autopilot Simrad AP70 MKII with processor AC80 and Compass Precision 9
- [1] Pushbutton panel for immediate propulsion commands
- [1] Backup Trackball
- [1] Accelerometer package for lighting control in wheelhouse
- [1] Package for Remote Assistance

[Modifications/Integrations to the above configuration of Navigation Equipment are reported in Annex D]

AUDIO-VIDEO SYSTEM:

Owner's Cabin:

- Samsung Smart TV Led 43" 4K
- [1] HDMI & USB Wall Plate
- - Streaming: Netflix, Disney+ ecc. via Smart TV. Spotify and Airplay2 via Crestron NAX amplifier
- [2] Dynaudio P4-W65 speaker 6,5" rectangular
- [1] Apple iPad Mini 6 64GB Wi-Fi (Crestron configured)

Main Salon:

- Samsung Smart TV 65" 4K Qled
- [1] HDMI & USB Wall Plate
- Streaming: Netflix, Disney+ ecc. via Smart TV. Spotify via Marantz Cinema 60 amplifier
- [7] Dynaudio P4-W65 rectangular speaker 6,5"
- [1] JL-Audio Home sunwoofer 8" d108
- [1] Apple iPad Mini 6 64GB Wi-Fi (Crestron configured)

Vip Cabin (x1) Guest Cabin (x2) Equipment list per Cabin:

- Samsung TV LED 55" full HD for the Vip Cabin
- Samsung TV LED 32" Full HD for the Guests Cabin
- [1] HDMI & USB Wall Plate
- Streaming: Netflix, Disney+ ecc. via Smart TV. Spotify, Sirius and Airplay2 via Bluesound amplifier
- [2] Dynaudio P4-W65 rectangular speaker 6,5"
- [1] Apple iPad Mini 6 64GB Wi-Fi (Crestron configured)

External Area (Beach, Aft Deck, Bow and Flybridge):

- [10] JL-Audio waterproof Speakers 8.8"- 4x Aft Deck, 2x Bow, 4x Flybridge
- [8] Dedicated channel of Crestron NAX Streaming amplifier with Airplay 2 and Spotify Connect Streaming
- Party Mode Option will replicate settings of **Main Salon** and will merge AV of: **Flybridge, Aft Deck, Main and Lower Deck**

[Modifications/Integrations to the following Audio-Video configuration are reported in Annex D]

OPTIONAL LIST INCLUDED:

- Arch. MARCO CASAMONTI (Studio Archea, Florence) Exclusive Interior Designer Premium Package;
- Integrated Bridge console (SEASYacht);
- Carbonfibre staircase;
- Low emission windows in the main deck;
- RINA Class Certificate-Unrestricted Navigation (Pleasure)
- Nr. 4 Underwater lights on the transom (fixed white light)
- Dark / Metallic paint
- Day Head in the Salon
- Aft Control Station
- Parallel system
- Seamless Transfer: “No-Power-blackouts” smart technology in order to avoid the blackouts from switching the genset power onto the shore power supply;
- Flydeck mini pilot station;
- Gyroscopic stabilizer Seakeeper mod. 26: working at anchor (“Zero Speed”) and in navigation (“underway”)
- AIS + Weather Station;
- Night vision camera predisposition (camera not included);
- Outside tent aft-located (4 poles) and at bow (4 poles), and on the flydeck (6 poles): complete with (tot. 14) carbon fibre poles and micro-holed fabric (mesh type)
- Electric blind curtains in the Salon
- Electric blind curtains in the Lower Deck’s accommodations
- Electric black-out rollers in the Lower Deck’s accommodations
- One (1) 180Lt/hr Watermaker;

OPTIONAL LIST INCLUDED:

- CCTV (5-camera) system:
 - 3X Lilin Z5R6422X3 2Mega Pixel network camera with IR
 - 2x Lilin mini PTZ Cameras (no IR) cod. PZD6422EX3, in the Engine Room
 - 1x Lilin NVR6108E 8ch - 1000M port NVR recorder 8ch
- IT AND Wi-Fi:
 - 1x Peplink MAX HD1 Dome Pro 5G router with 4/5G and Wi-Fi built-in antennas
 - 1x Ubiquiti Dream Machine Pro Router wireless controller, Firewall
 - 1x Ubiquiti with 48 POE switch for all physical ethernet connections
 - 5x Ubiquiti Access Point UniFi 6 Long-Range 3000 Mbit/s PoE (distributed across all decks)
- Starlink predisposition
- Portholes sensors
- Monitoring System
- 15" Monitor in the crew mess with monitoring system redundancy
- 2 x External tables with up/down electric mechanism: 1 x aft cockpit & 1 x fwd area
- Air compressor, with n.3 connection points: 1 x aft area, 1 x bow area and 1 x Engine Room
- Teak on the Flydeck
- Garage capacity for:
 - Tender Williams DJ 505 deflatable [tender not included]
 - Jet ski (3-seat personal water craft) [jet ski not included]
- External Furniture under the port stair in the aft Cockpit, with predisposition for Icemaker or drawer-fridge (with 2 drawers)

AWARDS

WORLD SUPERYACHT AWARDS 2025

Semi-Displacement or Planing Motor Yachts - 30m to 39.9m.



WORLD YACHT TROPHIES 2024

Best Exteriors



AB YACHTS